

CROCODILE ADHESIVE NAIL



CROCODILE



**Good
Adhesion to
All Surfaces**

Solvent-Based Adhesive

**Good
Adhesion to
All Surfaces**



CROCODILE ADHESIVE NAIL

High Performance Construction Solvent - Based Adhesive

- Good adhesion to various surfaces, vertical or horizontal
- Fast setting and highly adhesive
- Solid and non-sagging when cured
- Weather, UV and vibration resistant
- Safe to use on foamed polystyrene and mirror
- Paintable

- For cornice, decorative stone, concrete, plastic and metal, etc. -

CROCODILE ADHESIVE NAIL

High Performance Construction Solvent - Based Adhesive

“Good adhesion to all surfaces”



Application Instruction

Substrate Preparation

- The substrate must be clean, dust-free and without any traces of oil, laitance, curing compound etc.

Application

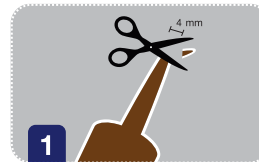

Cut off the nozzle tip at least 4mm wide and position the cartridge in a manual or air powered caulking gun.

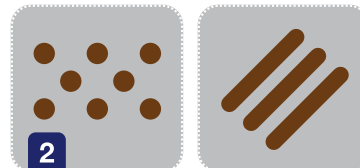

Apply adhesive on the surface as follows :

- Apply in spots on uneven surface.
- Apply in straight vertically if the attached object is small or attached horizontally.
- Apply in zigzagging line if the attached object is large and attached vertically.

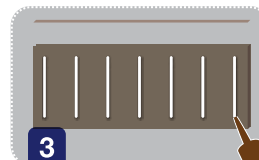

Distance between each line should be 5-10 cm, depending on the weight of the attaching object. (Before pressing the object, attach the object and pull back out (leave it for 3-5 minutes) before reattaching the object to open the adhesive surface, allowing the adhesive to touch both objects and surfaces, then press the object tight to the surface)

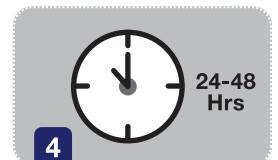

If the object is heavy, clamps or supports might be needed until the adhesive is completely cured. Leave for 24 - 48 hours before use or painting.

Packing

- 300 ml



Product Information



Usage Area

Crocodile Adhesive Nail is high performance construction solvent-based adhesive, fast setting and highly adhesive to various surfaces. It can be used in place of traditional nailing in construction and maintenance, for interior and exterior works and set faster than the water-based adhesive. After completely cured, the adhesive can take over 180 kg/sq.m. and can be used for various types of surfaces such as wooden cornice, wooden ears, synthetic wood, stone, decorative stone, vinyl, concrete, brick, fiber cement rood, plaswood, MDF wood, uPVC, other plastics, metal, clear glass, mirror, foam, etc.